



MEMORANDUM

DATE: May 26th, 2026
TO: Koren Lam
Senior Planner, Lanark County
99 Christie Lake Road, Perth
FROM: Stefanie Kaminski
Manager, Land Development, Regional Group
1737 Woodward Drive 2nd floor, Ottawa
SUBJECT: Draft Plan Update – Mill Run Extension (09-T-23003)

The objective of this memorandum is to outline the revisions to the Draft Plan of Subdivision for the Mill Run Extension file (09-T-23003) in Mississippi Mills (Appendix 1). The previously circulated Draft Plan is based on Concept Plan (CP) 12B (Appendix 2), while the revised Draft Plan reflects the changes introduced through CP15 (Appendices 3 and 4).

The primary change between these two plans is the removal of road and lot development of what was known as Phase 8 in CP 12B (generally lands west of Sadler Drive). These lands will remain as wetland with planned enhancements to the wetland. As a result of this removal, the lands that formerly comprised Phase 7 in CP 12B have been reconfigured and divided into two phases (Phase 7 and 8), reflected in CP15. The restructuring resulted in changes to the overall unit count (see table below).

	Concept Plan 12B	Concept Plan 15
Detached	71	44
Bungalow	0	26
2-Storey Towns	60	28
Total	131	98

The mix of housing typology remains largely unchanged, consisting of detached and town homes. Additionally, the road pattern of Street 1, Street 2 and Sadler Drive. It should be noted that the Stormwater Management (SWM) Pond decreased in size due to reduced development area, reflected in CP 15 and the revised Draft Plan. Servicing of the lands remain similar to the previous draft plan, and there are no changes to the transportation or geotechnical recommendations.

Overall, the revisions introduce only minor adjustments, while the community layout, housing types, servicing and road network remain largely consistent with the original plan.

Thank you,

A handwritten signature in black ink, enclosed in a thin black rectangular border. The signature is cursive and reads "Stefanie Kaminski".

Stefanie Kaminski

Manager, Land Development

skaminski@regionalgroup.com | 613-230-2100 x7301

Appendix 2: Concept Plan 12B

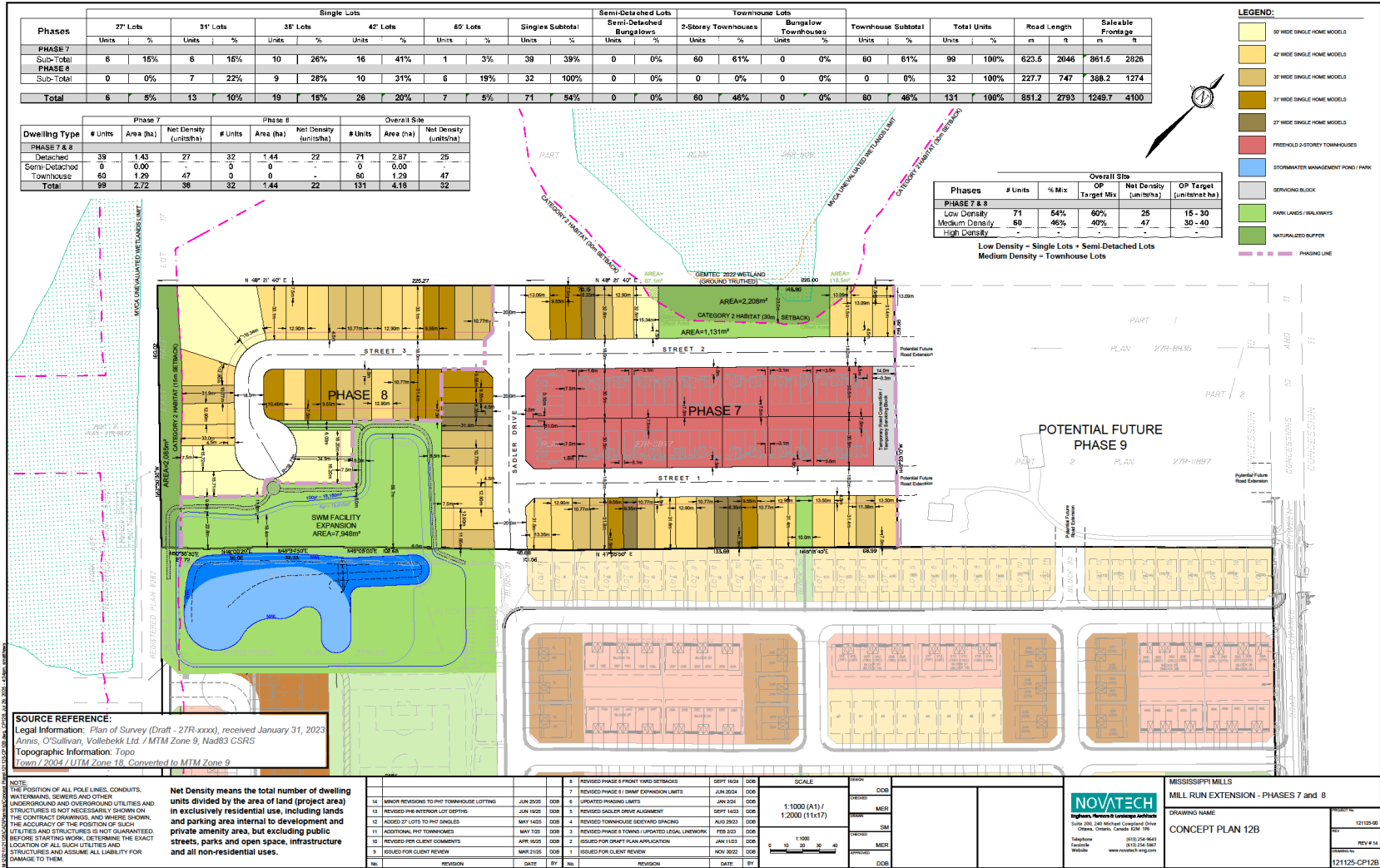

Appendix 3: Concept Plan 15

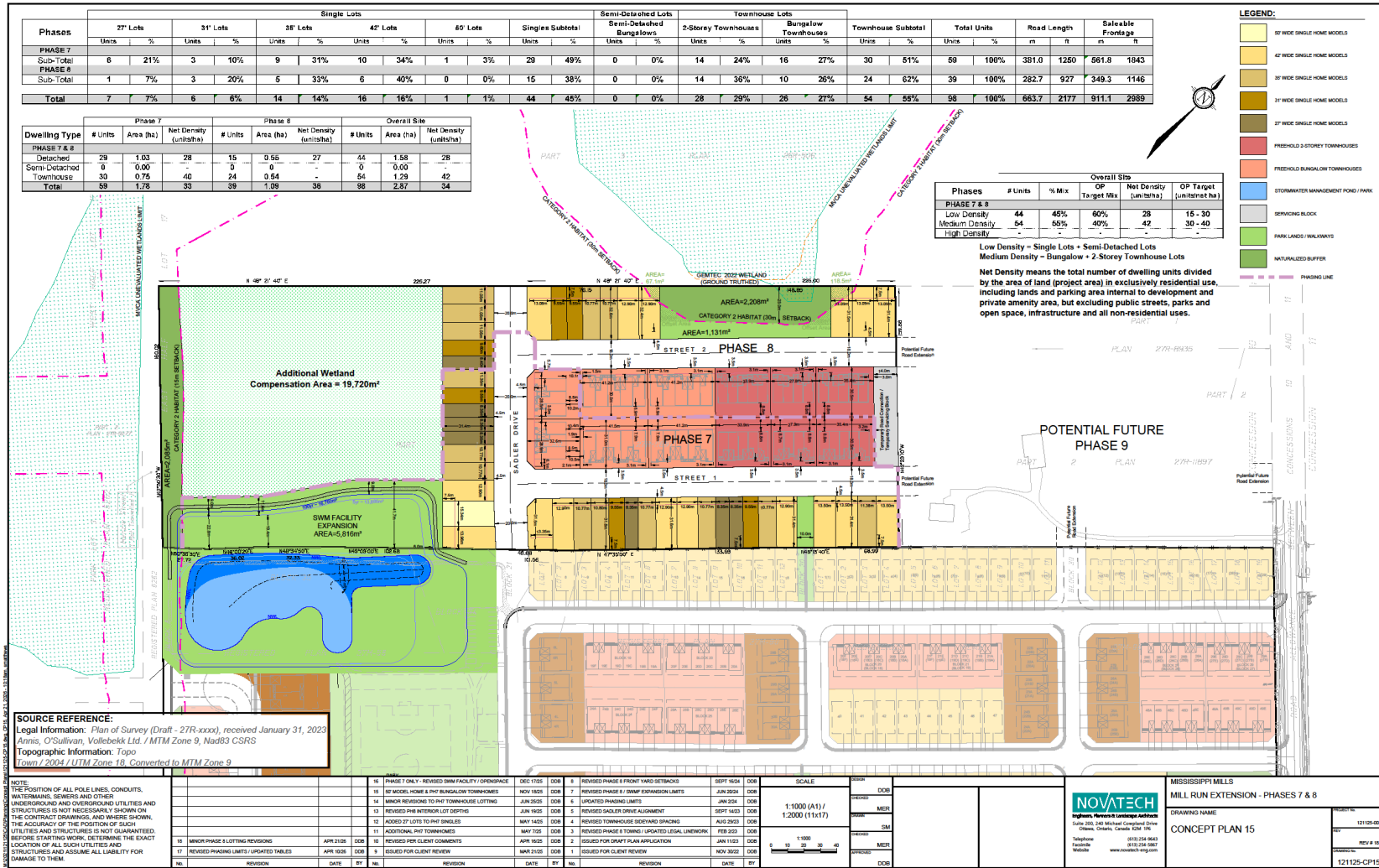

Appendix 4: Revised Draft Plan (CP15)

