

TREES 340 FRANK DAVIS						
Code	Qty.	Botanical Name	Common Name	Size	Condition	NATIVE
AR	3	Acer rubrum	Red Maple	60mm cal	B + B specimen	YES
AS	3	Acer saccharum	Sugar Maple	60mm cal	B + B specimen	YES
CO	2	Celtis occidentalis	Common Hackberry	60mm cal	B + B specimen	YES
GD	1	Gymnocladus dioica	Kentucky Coffee Tree	60mm cal	B + B specimen	YES
QM	1	Quercus macrocarpa	Bur Oak	60mm cal	B + B specimen	YES
QR	1	Quercus rubra	Red Oak	60mm cal	B + B specimen	YES
LL	3	Larix laricina	Eastern Larch / Tamarack	2.0m Ht.	B + B specimen	YES
PG	2	Picea glauca	White Spruce	2.0m Ht.	B + B specimen	YES
PS	5	Pinus strobus	White Pine	2.0m Ht.	B + B specimen	YES
SHRUBS 196 SQUARE METRES 375 PLANTS 340 FRANK DAVIS						
Code	Qty.	Botanical Name	Common Name	Size	Condition	Condition
HK	75	Hypericum kalmianum	Kalm St. John's Wort	30cm	Pot	YES
HP	150	Hypericum prolificum	Shrubby St. John's Wort	40cm	Pot	YES
RP	50	Rosa palustris	Swamp Rose	50cm	Pot	YES
SA	100	Spiraea alba	Meadowsweet	60cm	Pot	YES

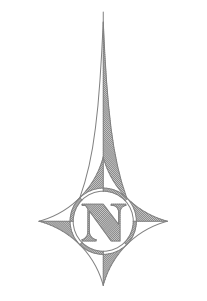

Drawing Remains the Property of/Copyright Reserved by Gino J. Aiello Landscape Architect. Do Not Use or Reproduce Without Approval of Gino J. Aiello.

**NOT To Be Used For Construction Unless** indicated by Revision: **FOR LANDSCAPE CONSTRUCTION!**

**Contractor is Responsible** for Verification of Site Locations of all Utilities. Report any Discrepancies Between Site and Drawing Immediately to Gino J. Aiello. Do NOT Proceed Until Clarified.

TURF AREAS TO BE SOD C/W 150MM DEPTH TOPSOIL ON APPROVED SUBGRADE | SOD TO BE #1 GRADE TURFGRASS NURSERY SOD per NSGA - Fine Fescue/Kentucky Bluegrass Sod | PLANTING MIX TO BE APPROVED BY LANDSCAPE ARCHITECT | PLANT MATERIAL TO MEET CNLA STANDARDS/BE APPROVED BY LANDSCAPE ARCHITECT PRIOR TO PLANTING ALL MATERIALS & WORK TO BE MAINTAINED UNTIL FINAL ACCEPTANCE. (MOWING TURF, WEEDING BEDS, WATERING TURF & PLANTS) & INCLUDE 1 YEAR WARRANTY FROM DATE OF FINAL ACCEPTANCE | PROVIDE WATERING OF ALL PLANT MATERIAL AS REQUIRED FOR PROPER ESTABLISHMENT, UNTIL END OF WARRANTY PERIOD | REFER TO CIVIL ENGINEER'S DRAWING FOR ELEVATIONS / GRADING |

The Landscape Plan is to be read in conjunction with the grading, servicing, site and survey plan | Bare root material to be planted in season only | All plant material locations to be staked on site by the landscape contractor and checked by the landscape architect prior to planting | All trees to be preserved on or directly adjacent to the site will be protected | Plant material are to be installed a minimum of 3.0m away from any part of any hydro transformer, 3.0m corridor between a fire hydrant and the curb, a 2.5m radius beside or behind a fire hydrant, 2.0m from any servicing/utility line or structure |

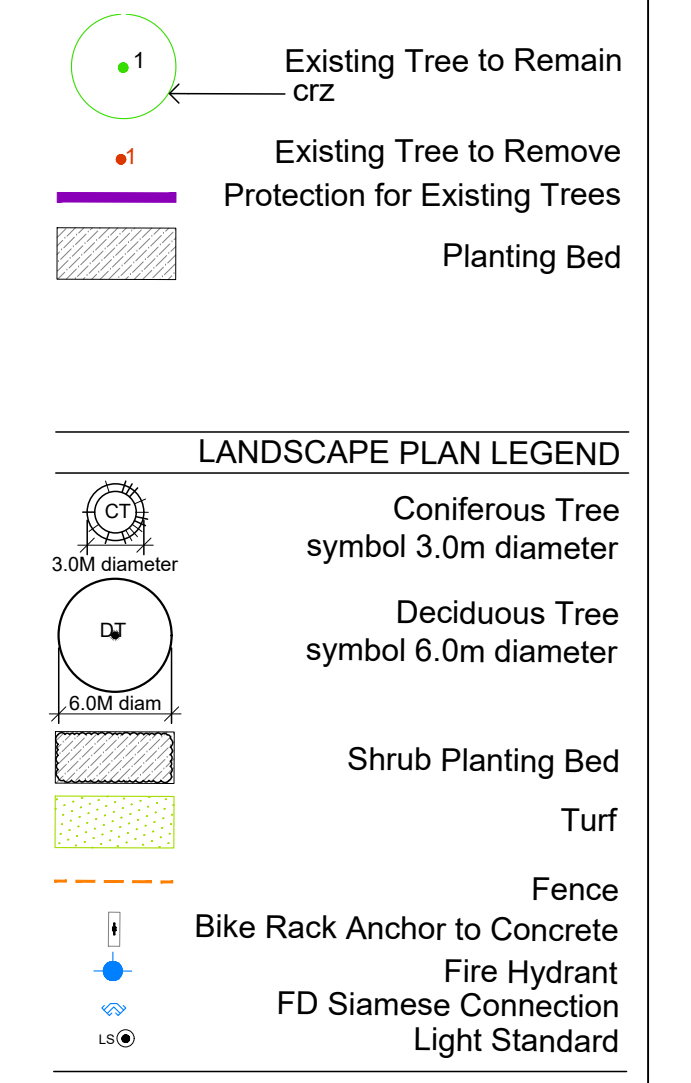

**PROFESSIONAL LANDSCAPE ARCHITECT**

1 MUNICIPAL PLANNING SUB 1 2024 05 01

0 REVIEW/COORDINATION 2024 04 00

# Revision Date

PROPERTY OWNER

**RAC BUSINESS BAYS INC.**

**GJA INC.**

GINO J. AIELLO | LANDSCAPE ARCHITECT

GJALA.COM | 613 286 5130 | GINO@GJALA.COM

115 DEBILITY ROAD UNIT # 1, ST THOMAS ONTARIO | N7T 5C2

**INDUSTRIAL BUSINESS BAYS**

LOT 5 / 6, 340 FRANK DAVIS STREET ALMONTE ONTARIO

**Landscape Plan**

**L1**

Scale: 1:300